

Box with Decorative Insert

Demonstrated by Bruce Wood

Start with block 75x75x90. This project is best done with two 50mm chucks.

Turn the block between centres, down to 71mm diameter. Then turn a 50mm spigot x 4mm high on the base end of the box and mount the block by that spigot in a 50mm chuck. Turn or drill a 60mm dia hole x 5mm deep for the lid insert. Drill 50mm dia hole, 36mm deep, into the top of the box. Sand and finish the upper 10mm of this hole. Keep the wood in this chuck.

Place the insert piece for the lid between centres and turn just a 46mm spigot on the side that is to be uppermost. Hold this in a 50mm chuck and turn it down to 60mm dia. With the face that will be inside the box perfectly flat, sanded and finished. Keep this wood in the chuck and mount it on a reverse adaptor in the tailstock.

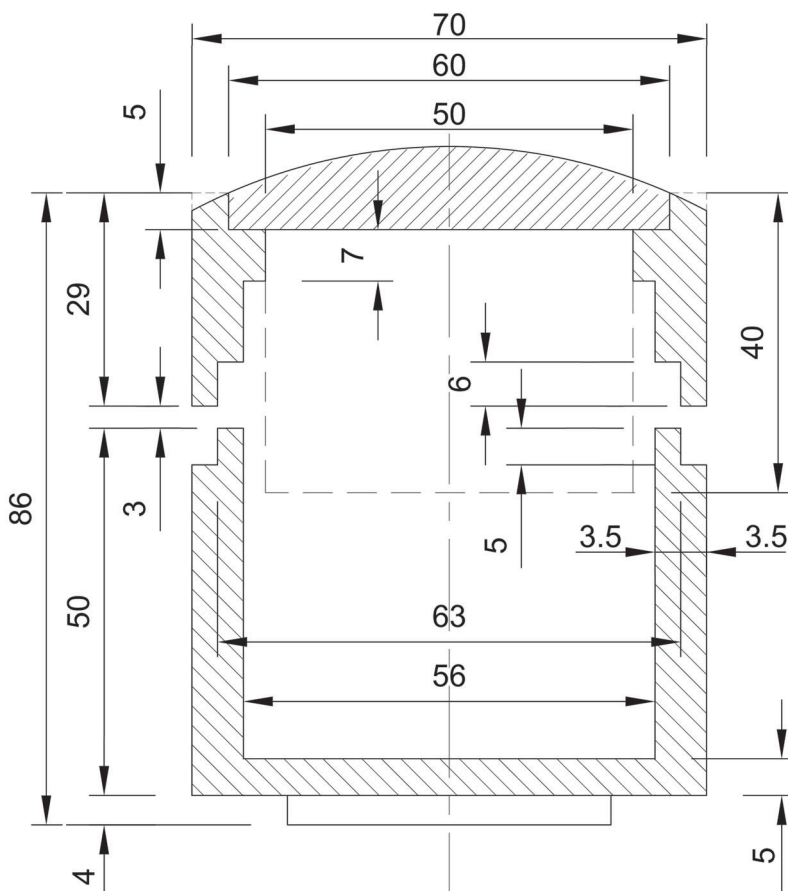

Return the box block, still in its chuck, to the headstock. Add medium superglue to the lid insert rebate. Bring the tailstock with lid insert up to the box and press into rebate. When the glue has set remove the chuck from the tailstock end.

With the box still in the chuck, part off the lid. Hollow out the base and cut the rebate for the lid. Sand and finish inside the base.

Mount the lid in the head stock. Cut the rebate to fit it to the base. Finish hollowing up to the insert. Sand and finish the inside.

Place the lower part of the box on the lid. Bring up the tailstock to hold it in place. Turn to the entire box to the final diameter. Add any decorations, sand and finish. Apply tape to hold the two box parts together. Turn it around in the chuck. Cut the top to a gentle curve. Sand and finish.

Jam chuck the base onto a block of wood or hold it in a 70mm chuck. Turn off the spigot and cut the base to a slight concave. Sand and finish.