

The Nova Neptune Lathe in Use P1

Bowl Under-side

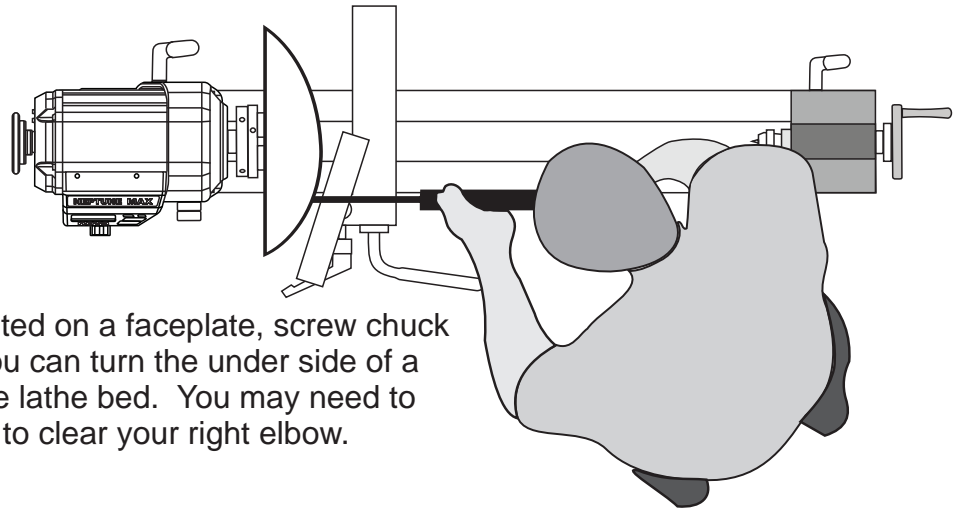

With the wood mounted on a faceplate, screw chuck or drilled dovetail, you can turn the under side of a bowl directly over the lathe bed. You may need to remove the tailstock to clear your right elbow.

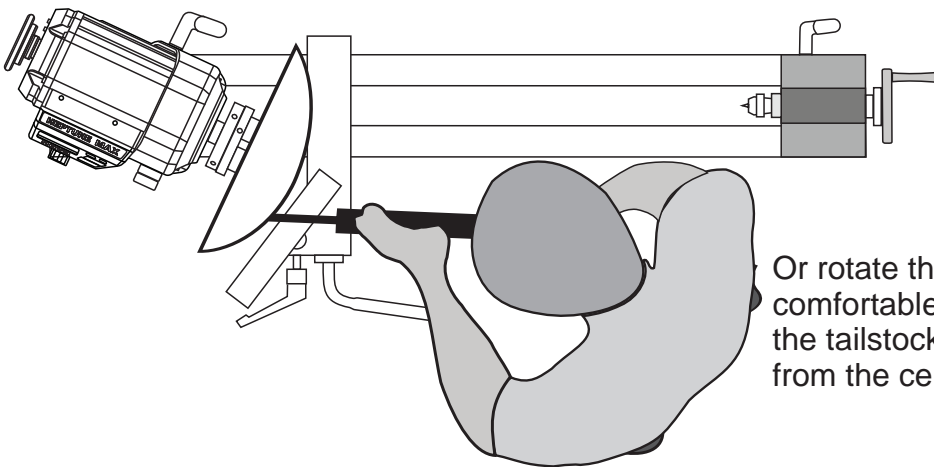

Or rotate the head a little for a more comfortable posture, clearance from the tailstock, and easier downhill cuts from the centre to edge of the bowl.

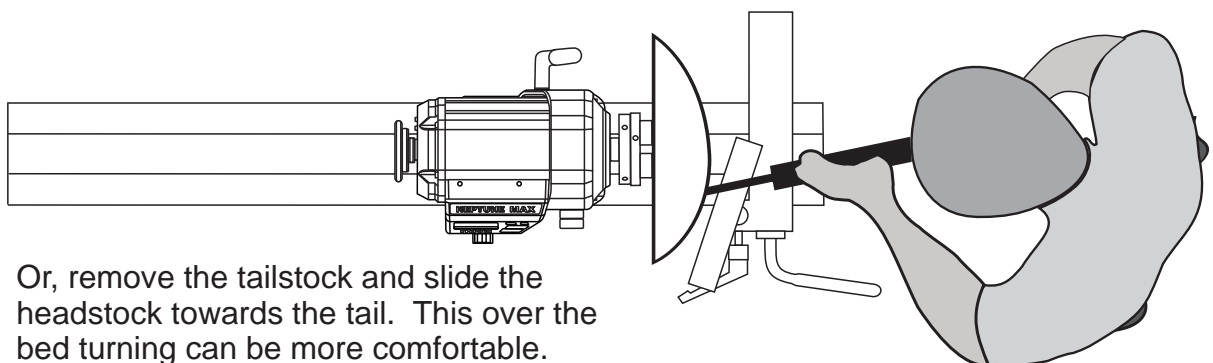

Or, remove the tailstock and slide the headstock towards the tail. This over the bed turning can be more comfortable.

The Nova Neptune Lathe in Use P2

Inside the Bowl

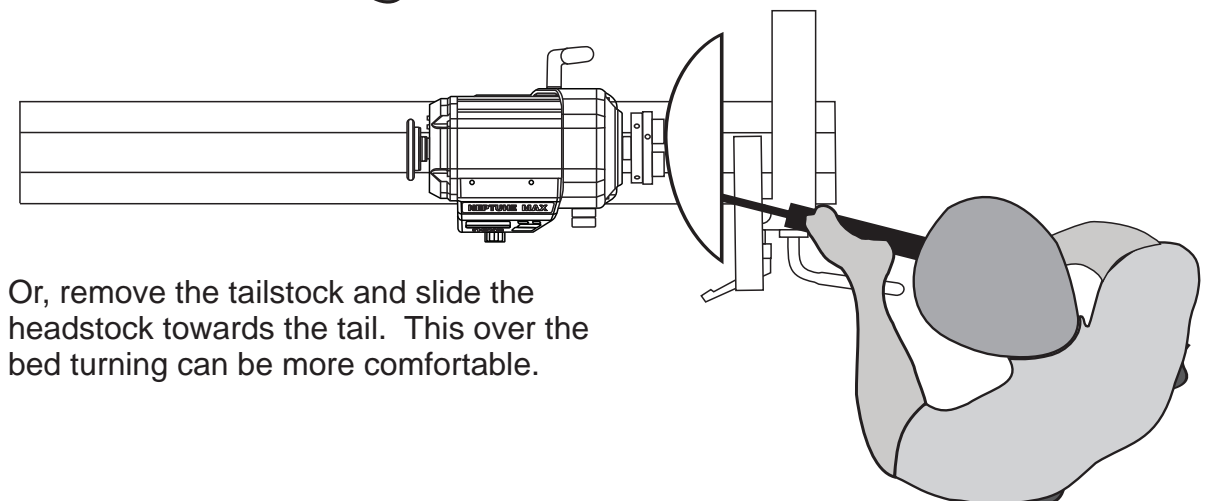
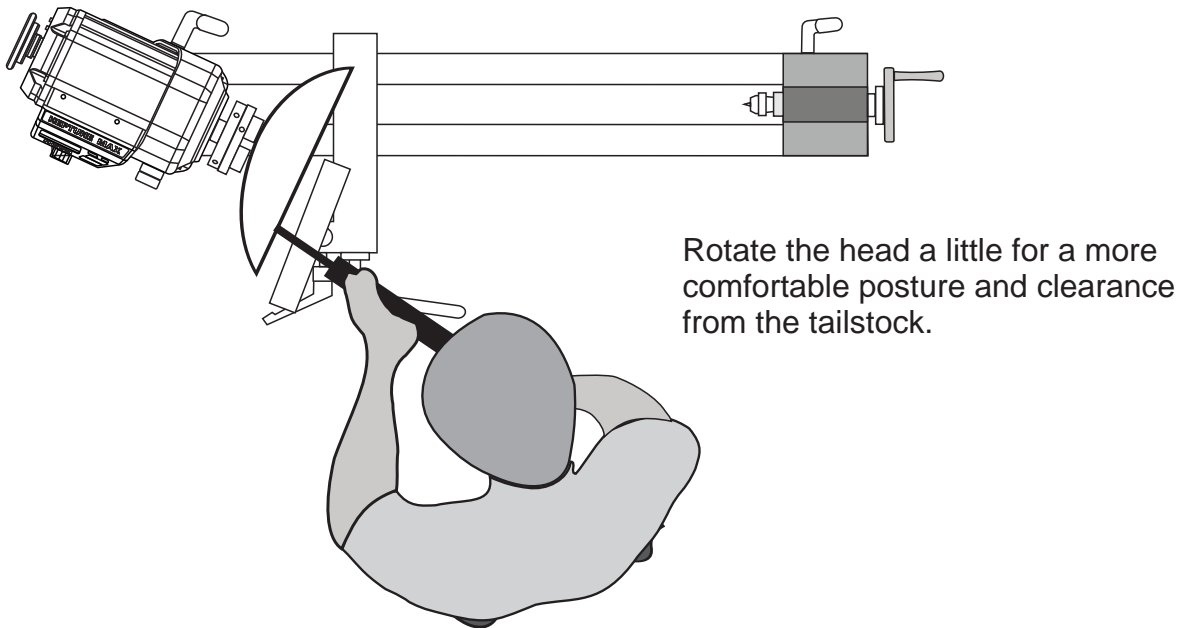
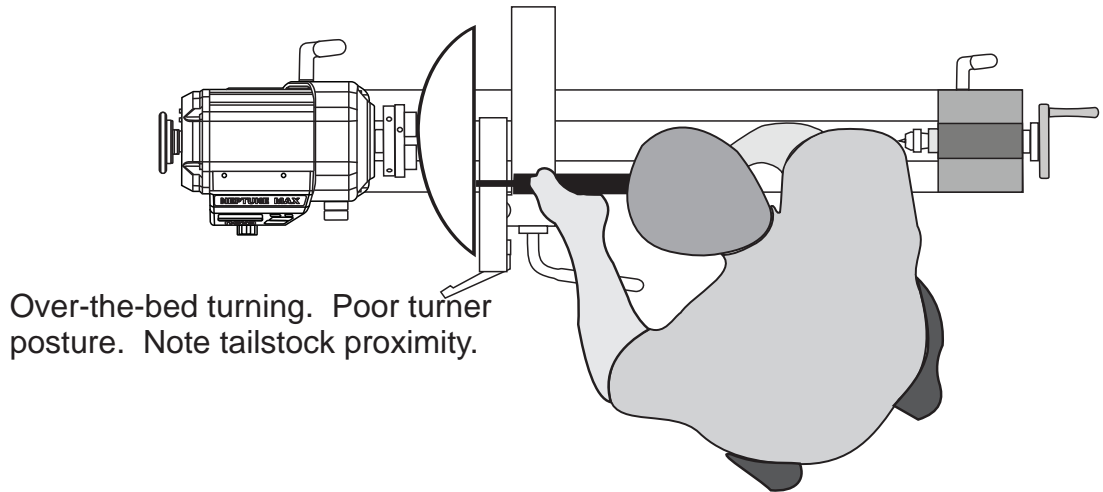

The Nova Neptune Lathe in Use P3

Bigger Bowls Outside

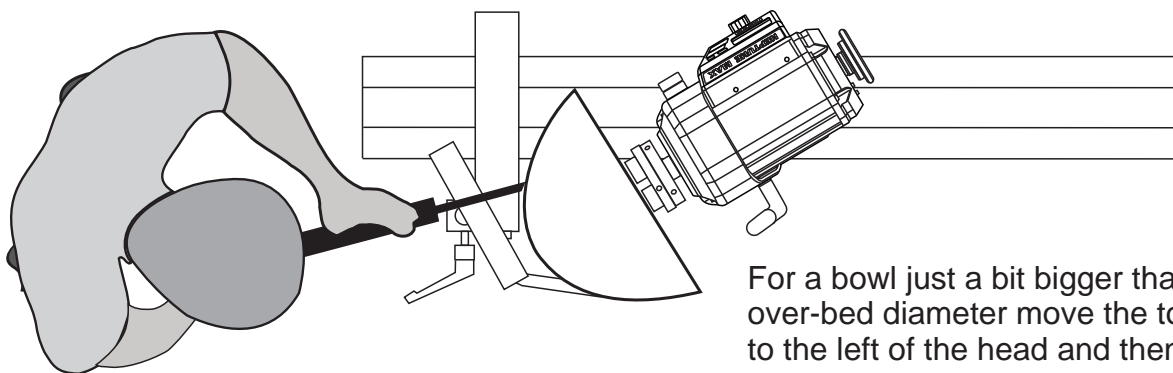

For a bowl just a bit bigger than the over-bed diameter move the toolrest to the left of the head and then rotate the head to suit.

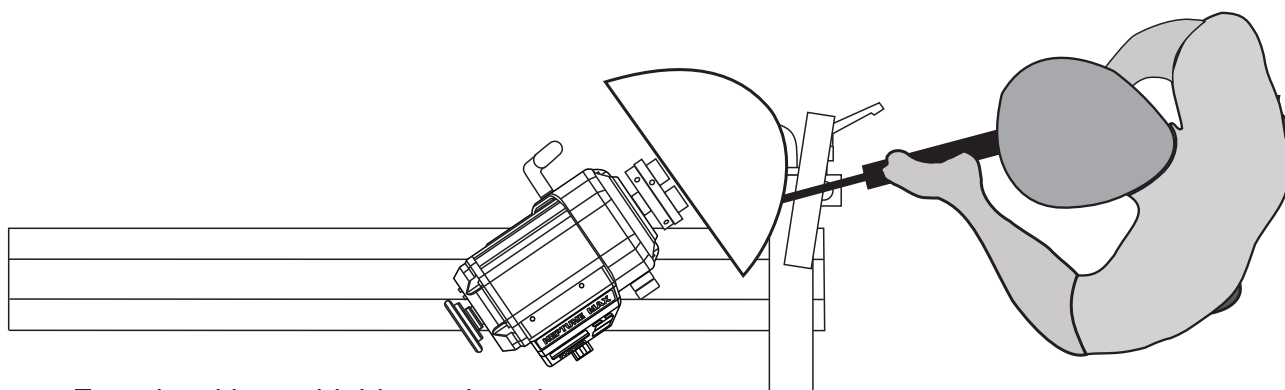

For a bowl just a bit bigger than the over-bed diameter move the head and toolrest to the tail end of the lathe.

The Nova Neptune Lathe in Use P4

Bigger Bowls Inside

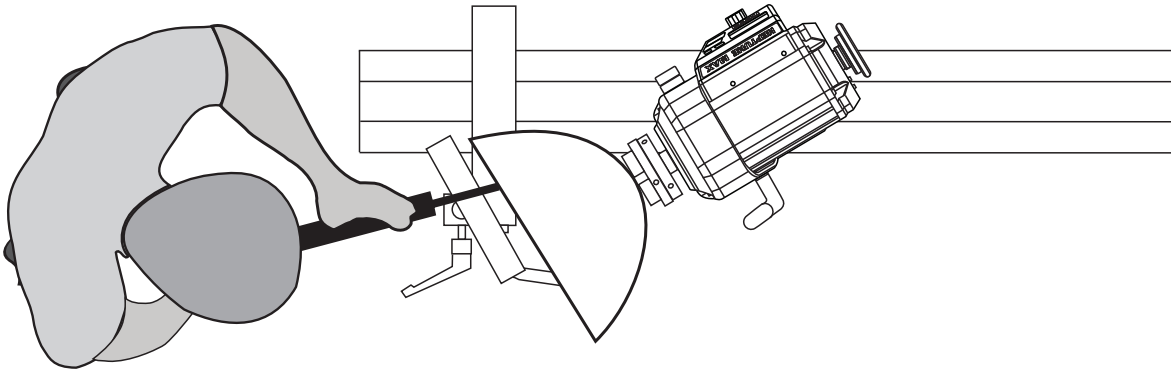

For a bowl just a bit bigger than the over-bed diameter move the toolrest to the left of the head and then rotate the head to suit.

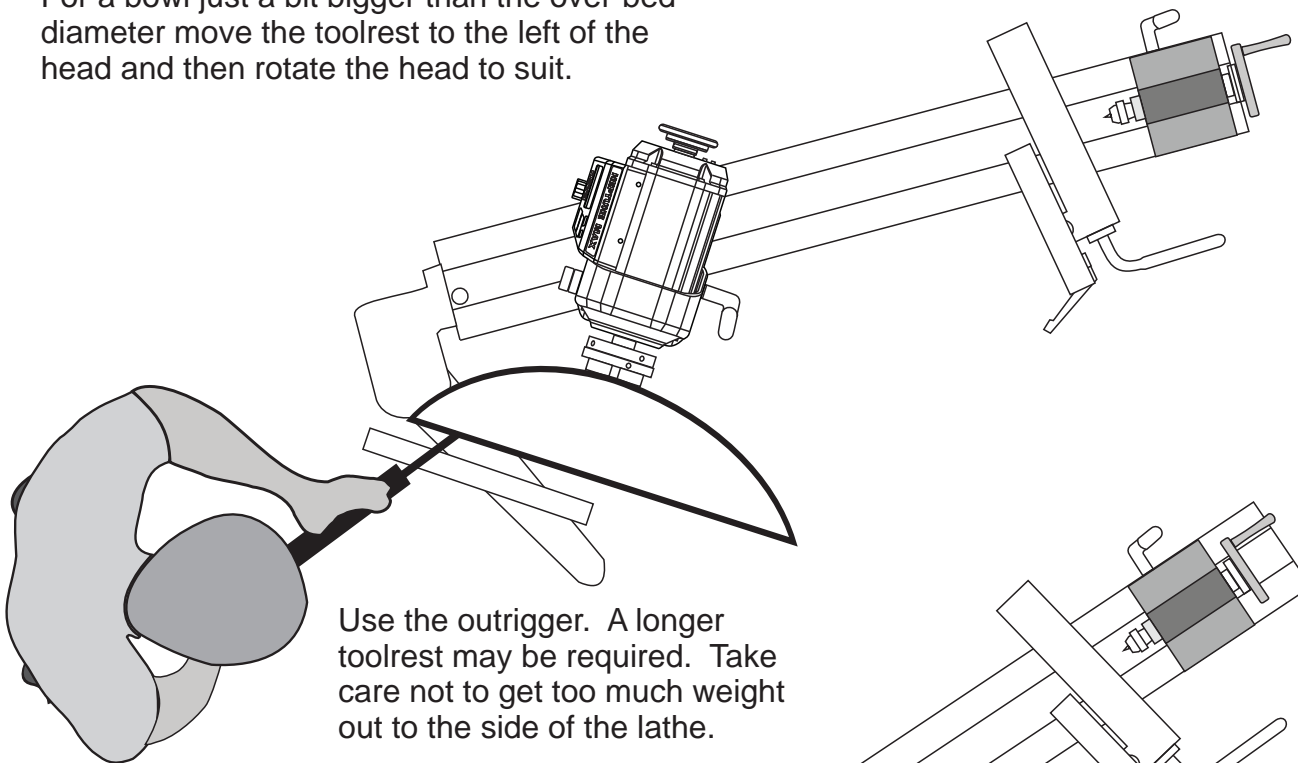

Use the outrigger. A longer toolrest may be required. Take care not to get too much weight out to the side of the lathe.

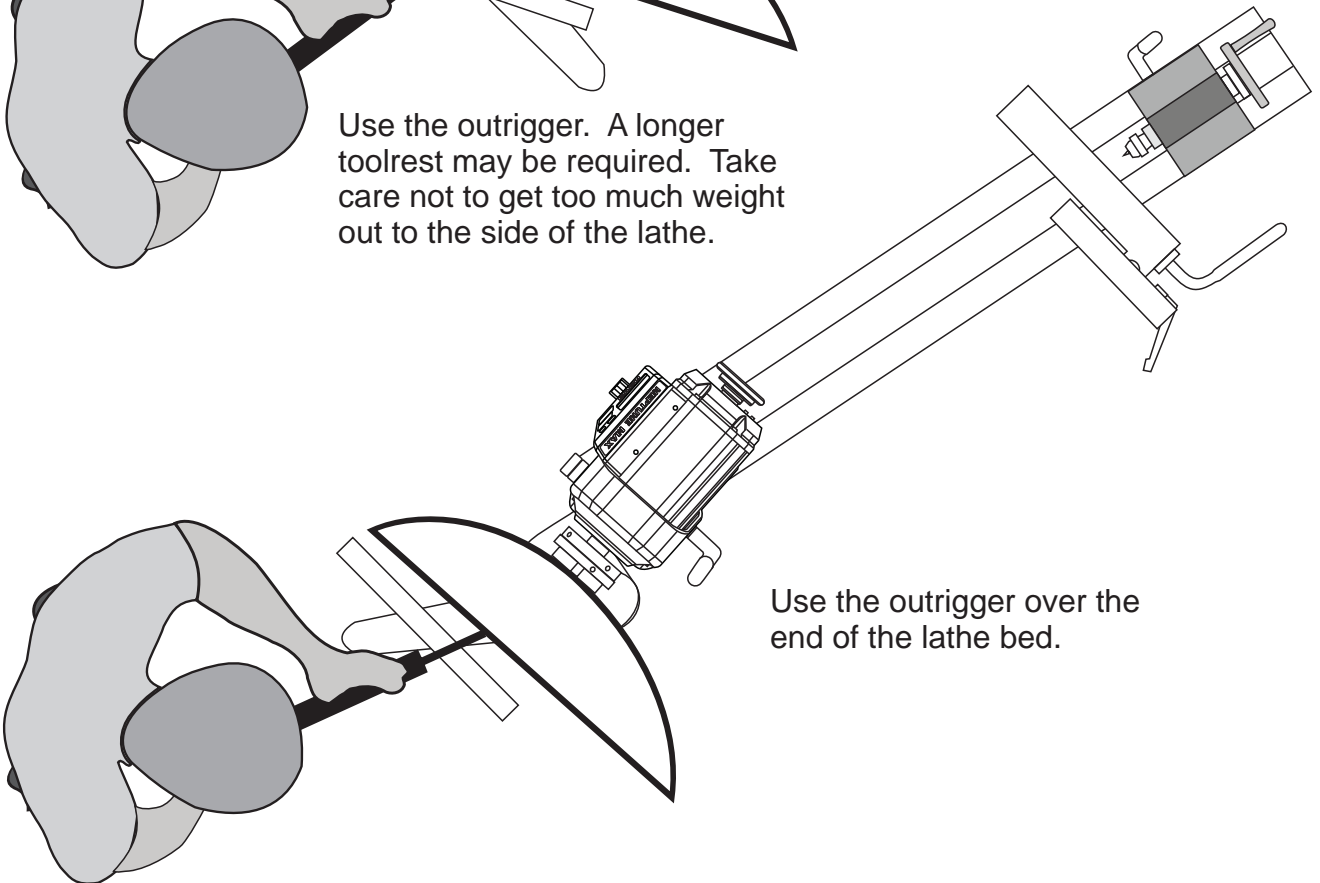

Use the outrigger over the end of the lathe bed.

The Nova Neptune Lathe in Use P5

Much Bigger Bowls

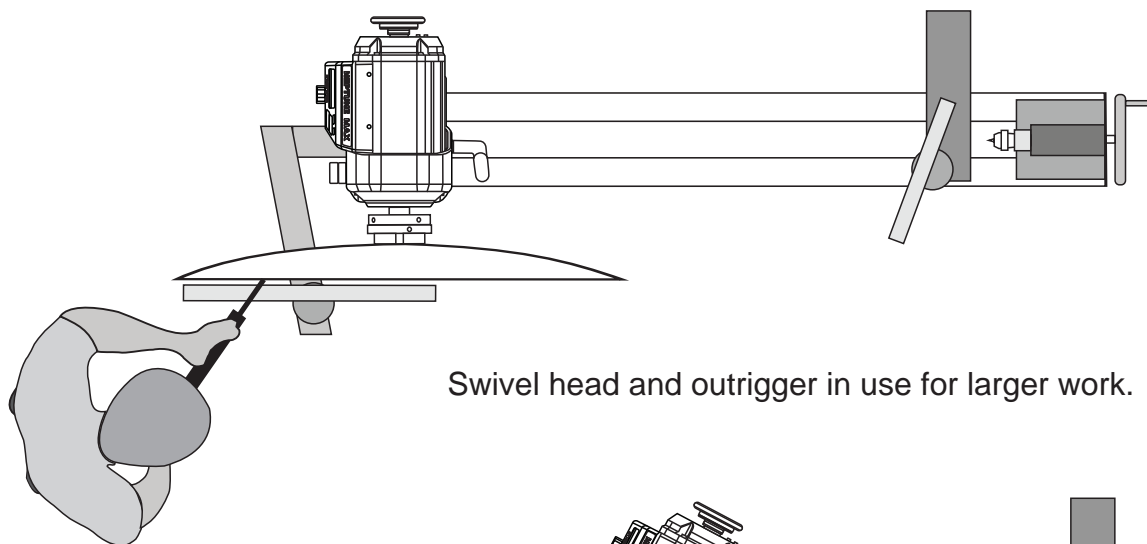

Swivel head and outrigger in use for larger work.

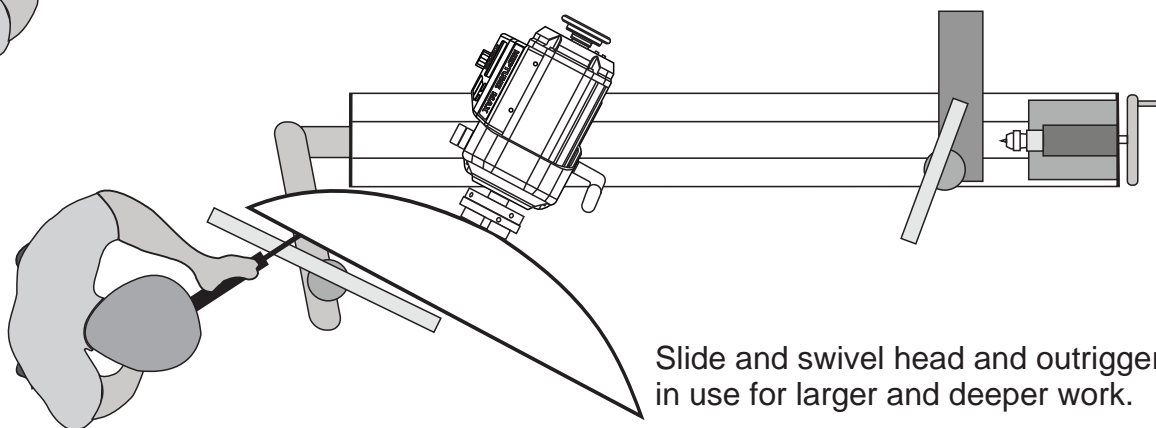

Slide and swivel head and outrigger in use for larger and deeper work.

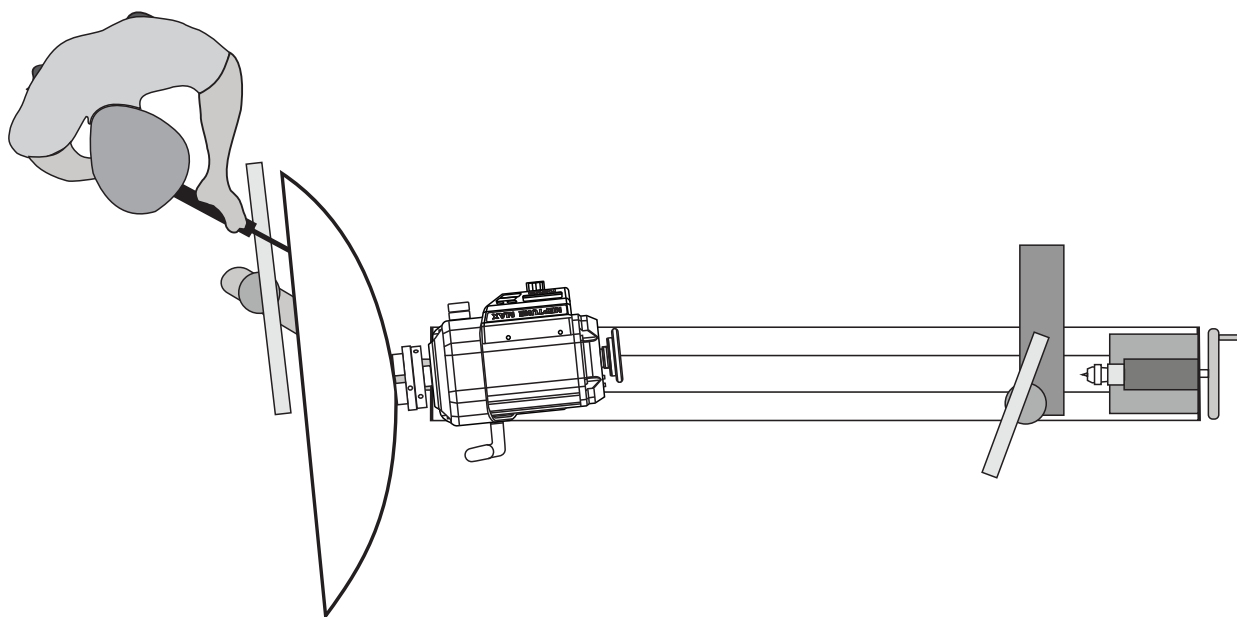

The Nova Neptune Lathe in Use P6

Spindle Turning

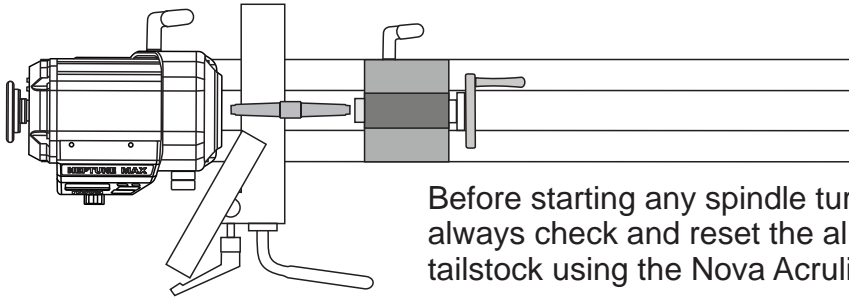

Before starting any spindle turning or between-centres work always check and reset the alignment of the head to the tailstock using the Nova AcruLine double-ended morse taper.

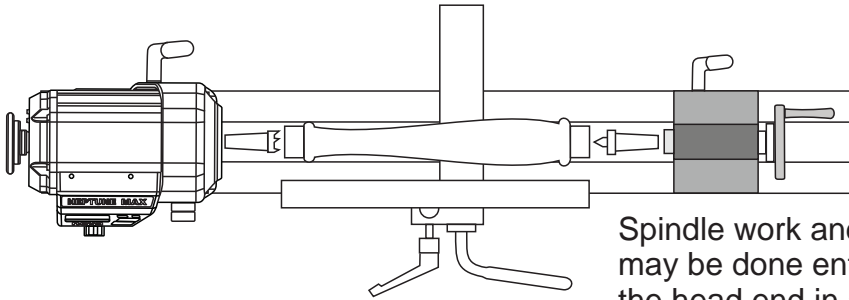

Spindle work and other between-centres work may be done entirely between centres or with the head end in a chuck and the tail brought up for security for most of the turning.

Hollow Form Turning

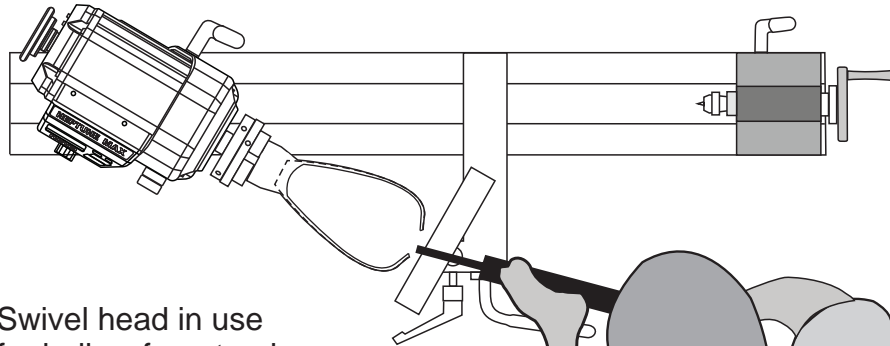

Swivel head in use for hollow form turning.

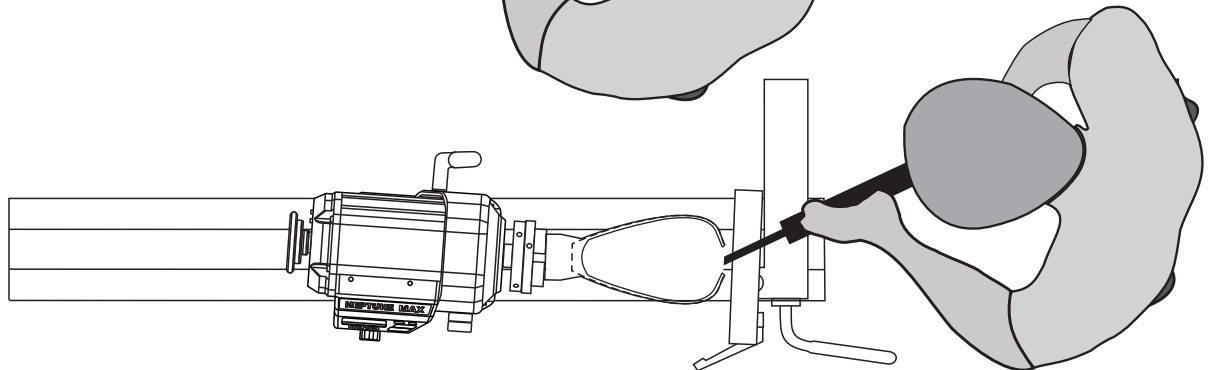

Remove the tailstock and slide the head for hollow form turning over the bed of the lathe.

The Nova Neptune Lathe in Use P7

A wide hollow form or seriously undercut bowl rim.

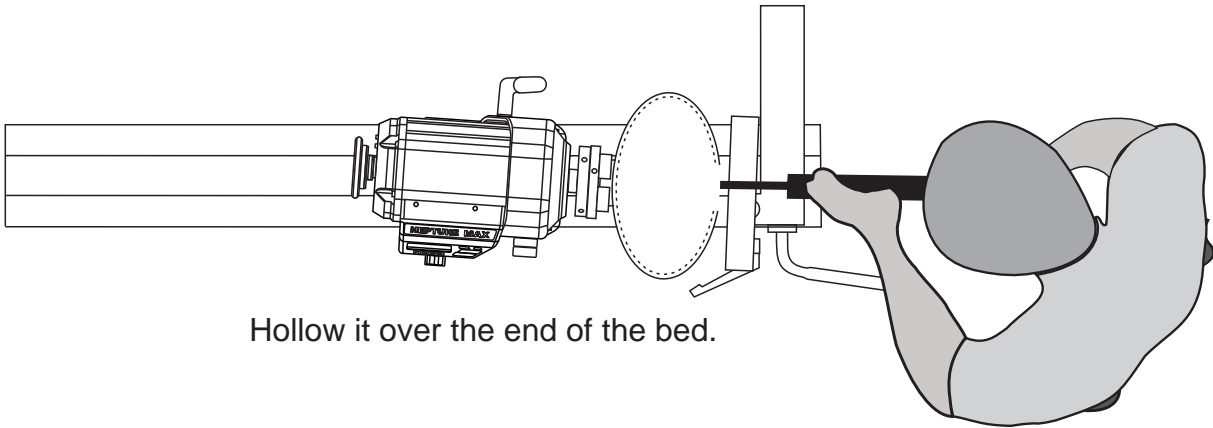

Hollow it over the end of the bed.

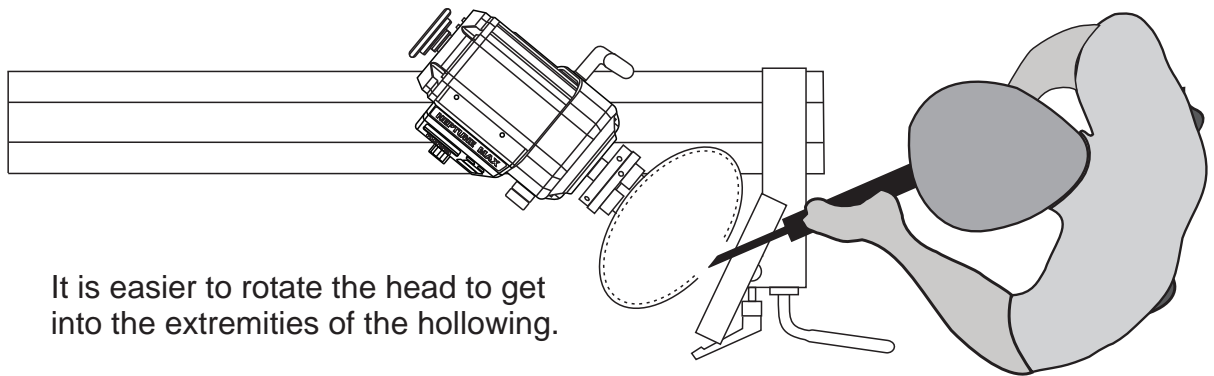

It is easier to rotate the head to get into the extremities of the hollowing.

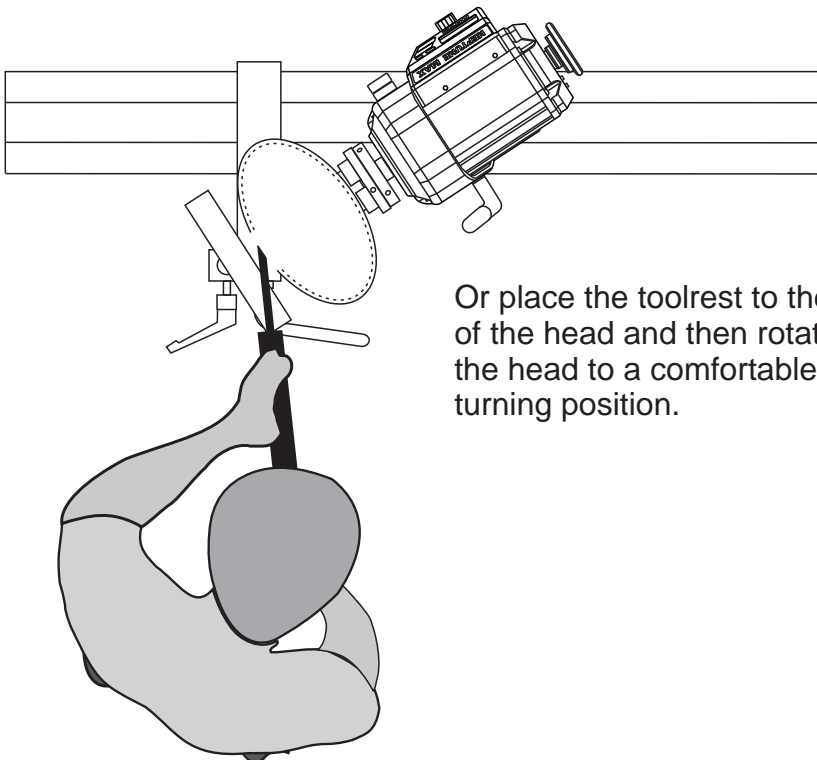

Or place the toolrest to the left of the head and then rotate the head to a comfortable turning position.