

Guilio's Burl-Top Box

Demonstrated by Bruce Wood

This project is easiest done with four different chucks. If you don't have them then make the insert pieces first and set them aside.

Turn the contrast colour insert material for the top between centres down to a bit more than 50mm dia x 18mm long plus a spigot for a 30mm chuck (or this can be done with a 47mm spigot for a 50mm chuck). Mount this in the chosen chuck and turn it down to exactly 50mm dia. You may keep it in this chuck.

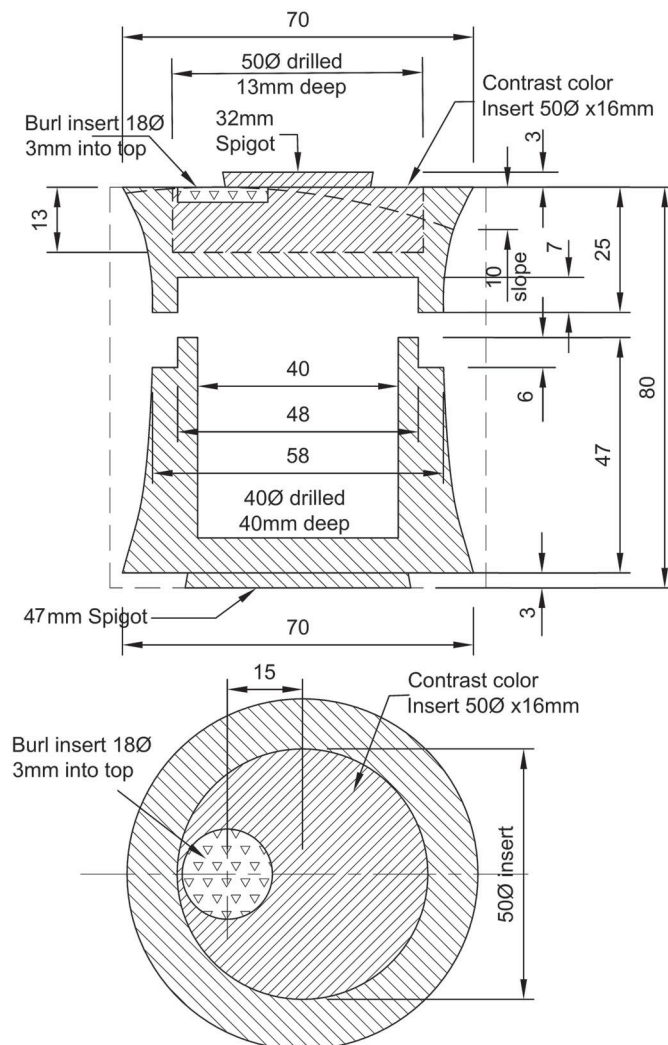

Turn a burl insert piece to 18mm x 4mm and set it aside.

For the body of the box: Start with a block 75x75x85 with the grain along the long axis. Turn this block between centres, down to 70mm diameter and make a 46mm spigot x 3mm deep on the base end of box. Mount the block in a 50mm chuck. Drill a 50mm dia hole 13mm deep into the lid end. Glue the main insert material into the top end of the box with the 30mm spigot exposed. Use the tailstock to press this in. Part off the lid and set it aside.



Hollow out the base 40mm diameter and 40mm deep. Turn the rebate for the lid 48mm dia x 6mm deep. Sand and finish inside the base. Set this part aside.

Mount the lid held by the spigot on the contrast colour insert. Turn the inside to fit the base. Sand and finish the inside. Keep this part on the chuck.

Fit the base to the top part and bring up the

tailstock to keep it in place. Sand and finish the outside of the box. Use tape to secure the base to the top. Clean off the underside of the base. Sand and finish this area. Separate the parts and take them off the lathe.

Make an offset jam chuck to finish the lid. Remove two opposing jaws from a chuck. Cut the underside of a piece of scrap wood so that it can slide back and forth within that gap in the jaws. Make the upper side at least 70mm wide and 85 mm long. Slide the scrap wood towards one end of its travel and clamp it in the jaws. Turn the scrap wood down to diameters that will fit firmly inside the underside of the box lid and also be flush with the outside of the box lid. Ease the chuck and slide the scrap wood 15mm to include more of the unused end in the chuck. Put the box lid back on. Bring the tailstock close to the wood – this will be the centre of the burl insert. Rotate the box lid to get good grain orientation. Tape it to the scrap block. Bring up the tailstock for security. Turn the box top to a curve. Try for 10mm slope down to the outer edge. Cut an 18mm dia hole x 3mm deep at the centre. Glue in the burl insert piece and turn it off to the shape of the lid top. Sand and finish.