

## Multi-faceted Eccentric Bowl as shown by Rex Haslip

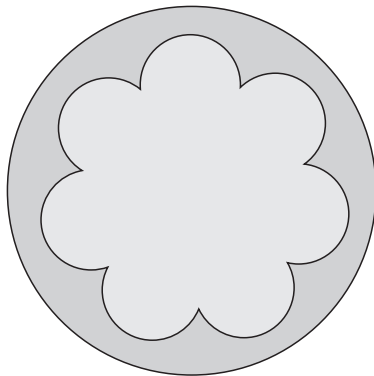

The idea is to make a bowl with indents down to the same depth as the centre and extending outwards from the central depression. Any number of these depressions can be cut

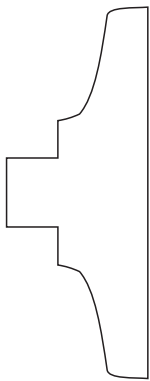

Make a bowl blank with a long spigot on the bottom. Note that the diameter of this spigot needs to be suitable for the next step of the project.

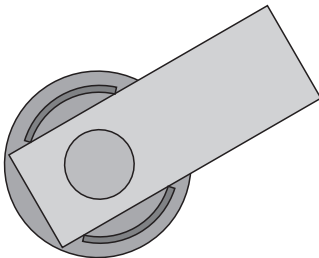

Remove two jaws from a scroll chuck. Make a piece of mounting wood narrow enough to fit between the remaining jaws, and longer than the radius of the bowl blank. Grip this near its end in the scroll chuck. Turn a hole towards one end of this wood into which the spigot on the bowl will fit firmly.

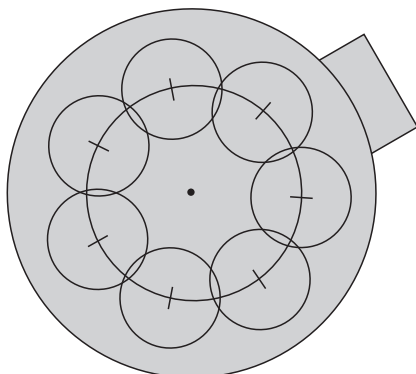

Fit the bowl into the hole in the mounting wood. The centre of the bowl is now the centre of the turning circle and you can plan your work in detail. Mark a circle where you want the centre of the off-centre cuts to be. Around this line mark where the centre of each off-centre cut will be. The off-centre cuts must meet or overlap or the bowl will not finish well. You do not need to mark the outline of every off-centre cut, but it helps to do so.

There are various ways to equally divide the circle for the off-centre cuts. You can use the indexing wheel on your lathe. For all other methods you will need a spot drawn at the bowl centre. The easiest way then is to use a cloth measuring tape around the outside of the bowl. Divide the measurement you get and draw lines from those points to the centre..

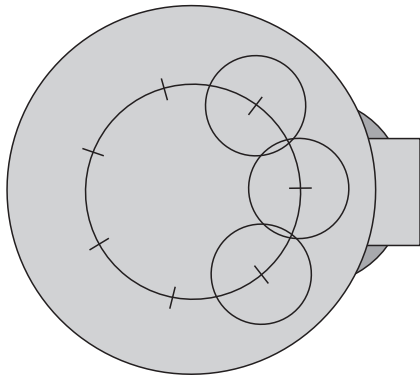

Rotate the chuck so that the mounting wood is horizontal. Bring the tailstock with a pointed centre in it up close to the face of the work. Slacken the scroll chuck jaws and slide the mounting wood across until the centre line of the off-centre cuts lines up with the point of the tailstock. Rotate the bowl in the mounting wood until the centre of one off-centre cut lines up with the point of the tailstock.

Shift the tailstock away and complete the first off-centre depression. A simple shape is suggested to start with as this will be easier to marry into the overall interior shape of the bowl.



Make a profile of the shape of this depression as you now have to make all the other depressions to the same shape.

Sand and finish this depression.

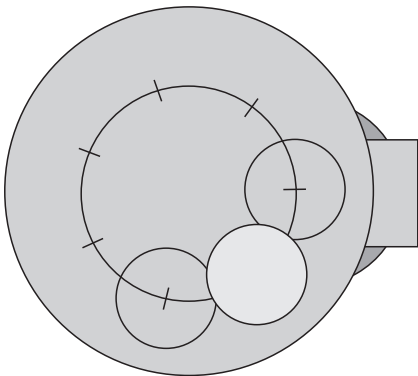

Bring up the tailstock. Rotate the bowl in the mounting wood until the centre of the next depression is in line with the point of the tailstock. Repeat the action to turn and complete each depression.

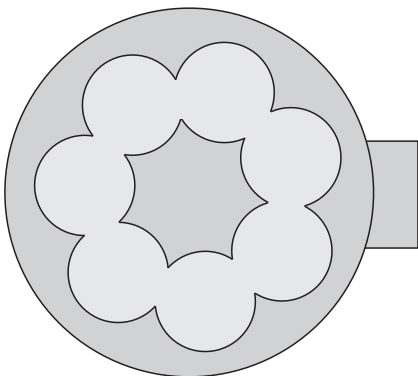

When all the off-centre depressions have been completed ease the scroll chuck jaws and return the mounting wood to its initial position. The centre of the bowl is now the centre of rotation.

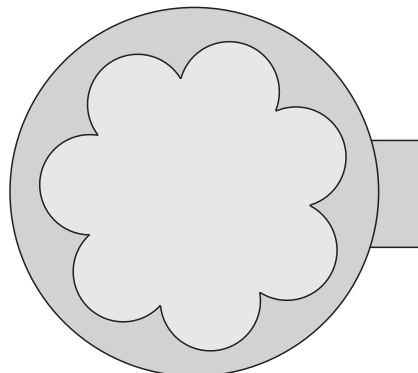

Hollow out the centre and finish the bowl. Take the bowl off the mounting wood and finish the bottom.